

Assembly manual

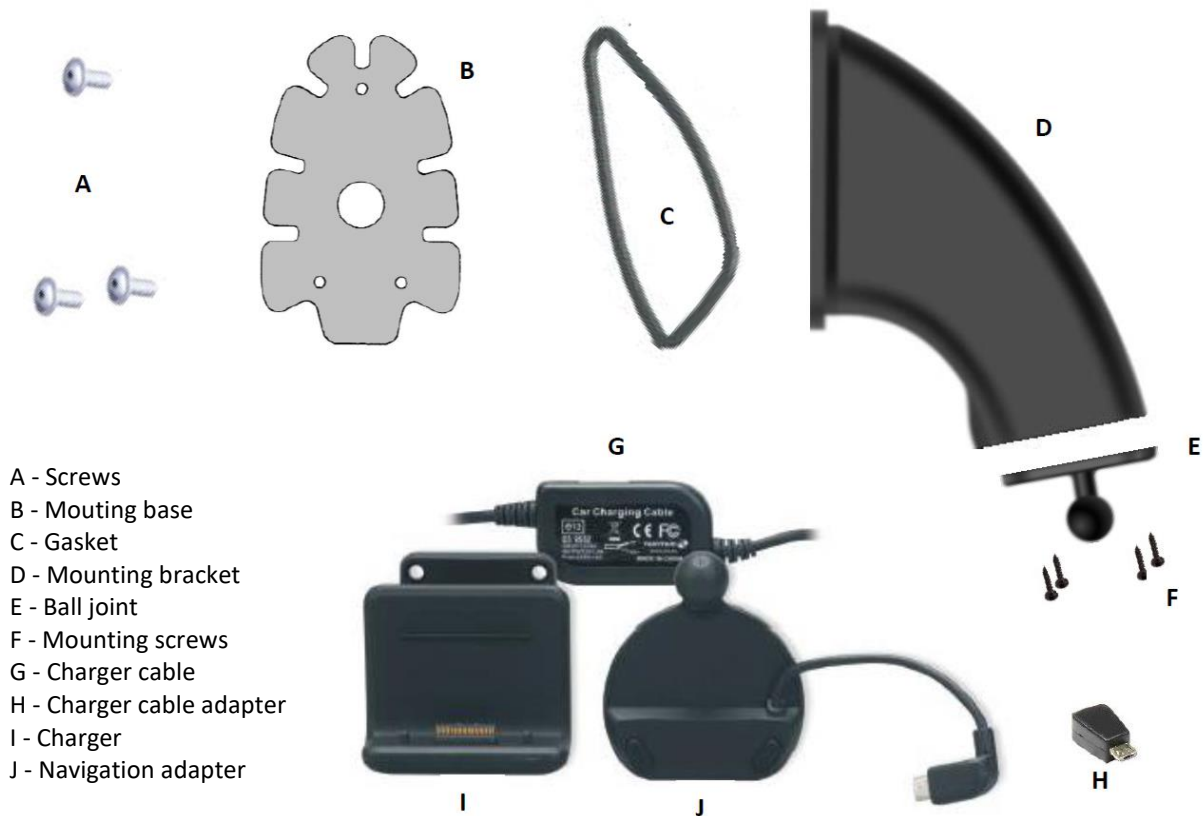

Package contains:



- A - Screws
- B - Mounting base
- C - Gasket
- D - Mounting bracket
- E - Ball joint
- F - Mounting screws
- G - Charger cable
- H - Charger cable adapter
- I - Charger
- J - Navigation adapter

Step 1

Locate the correct position for the Mounting bracket (D) suitable for the A-pillar in any vehicle. Pay attention to the position of the navigation unit. It should not be in the drivers line of sight but still in a good readable position.

Assembly samples

**Step 2**

Remove the A-pillar. Before any assembly, consult the OE's manual.



WARNING: AIRBAGS CAN BE LOCATED IN THE A-PILLAR!

Step 3

Locate the screw and holes for the Mounting Base. Place the base (B) in the inside of the A-Pillar. Indicate 4 holes, the 5mm are designed for the Screws (A). The biggest hole is designed to feed the Charger cable (G).

Step 4

Feed the Charger cable (G) through the Mounting bracket (D). Assemble the ball joint (E) with the included screws (A).

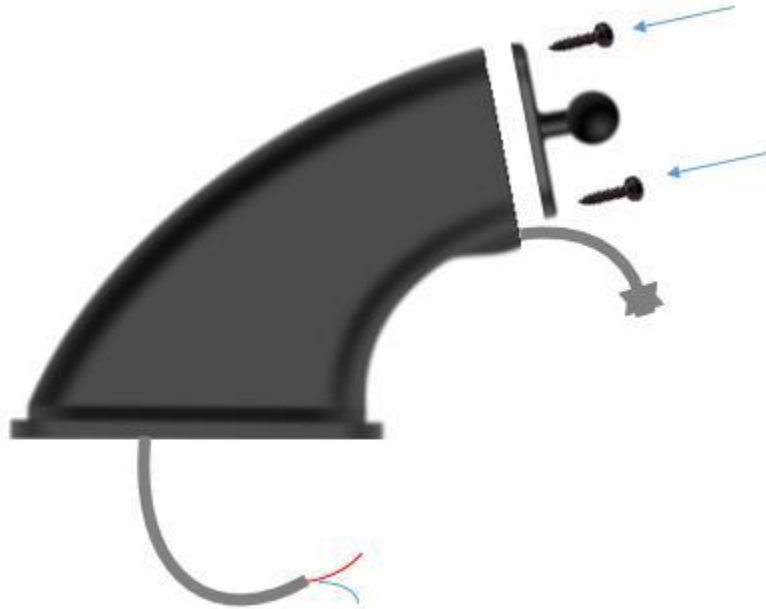

Step 5

Place the gasket against the Mounting bracket (D) and assemble the complete kit on the inside of the A-pillar. Lock the Mounting bracket (D) with the screws via the inside Mounting base (B).

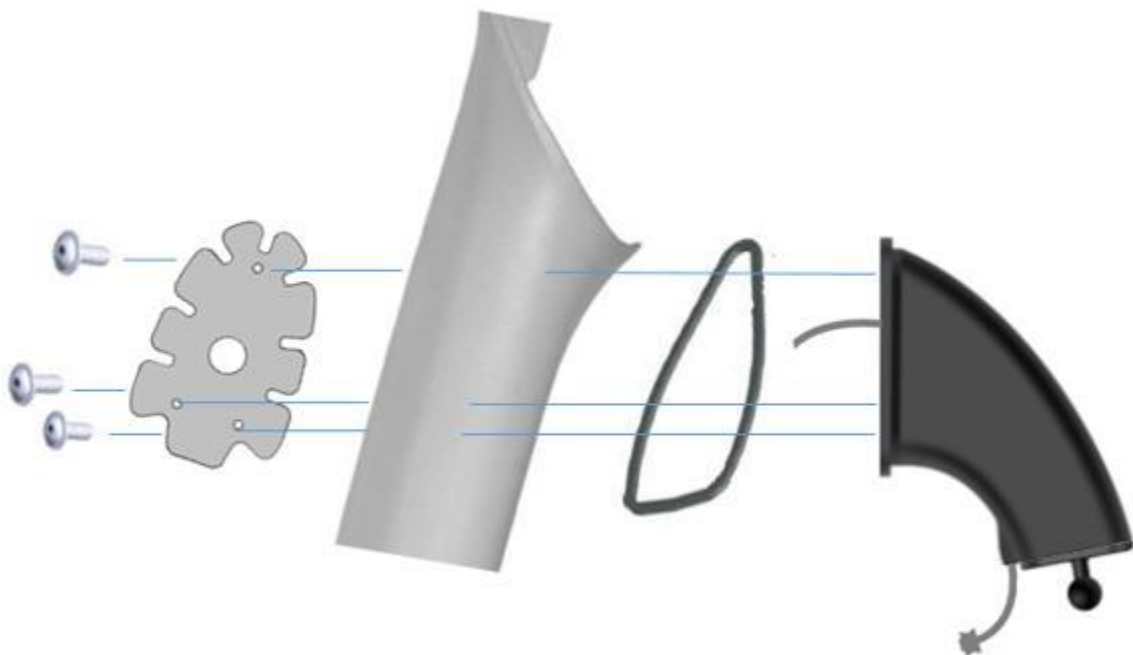

Step 6

Feed the Charger cable (G) through the inside of the dashboard en assemble the A-pillar back in its position.



- 12v ignition

- Ground

Option 1



Option 2



Option 1

Remove the suction cup from the original holder and replace it by the TomTom specific adapter (J). Connect the TomTom specific adapters power supply to the Navigation system.

Mount the Charger (I) to the ball Joint (E). Connect the Charger cable (H) to the adapter.



The TomTom unit is ready for installation on the Charger. Press the device gently on the charger for a magnetic fit.

Option 2

Remove the suction cup from the original holder and replace it by the TomTom Ball joint (E). Connect the Charger cable (G) to the original TomTom holder. If needed, use the charger cable adapter (H).

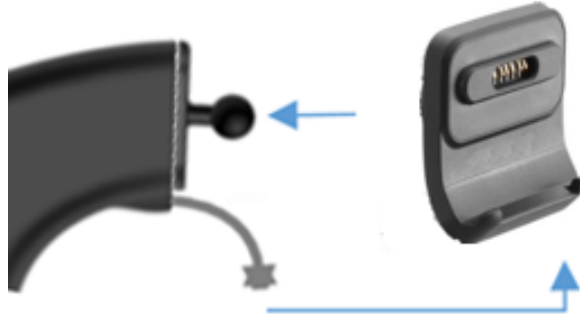

The TomTom navigation unit is ready to be fitted on the holder.